



Cadastral and Real Estate Advertising Office TULCEA  
Tulcea Real Estate Cadastre and Publicity Office

**EXTRACT OF THE LAND  
REGISTER CERTIFICATE  
FOR INFORMATION**

*Land Certificate No. 49098 Tulcea*

Request no.	<b>48099</b>
Day	<b>17</b>
Month	<b>04</b>
Year	<b>2024</b>

Verification code  
100166423418



**A. A. Part I. Property description**

land within the  
BUILT-UP AREA

**Address:** Loc. Tulcea, Str UNIRII, Jud. Tulcea Municipality

Item no.	Cadastral number Topographic number	Surface* (sqm)	Observations / References
A1	49098	5,203	Unfenced land; Intra-urban land delimited by the conventional boundary, of which 857 square meters of green space, 580 square meters of parking and 2106 square meters of pavement. Public domain

**B. B. Part II. Owners and documents**

Entries regarding property rights and other real rights		References
<b>59618 / 23/06/2021</b>		
Administrative Act no. 53, dated 25/02/2021 issued by the Local Council of Tulcea Municipality; Administrative Act no. 8117, dated 02/06/2021 issued by the Tulcea Heritage Maintenance and Administration Directorate;		
B1	Tabulation, PROPERTY right, acquired by law, current share 1/1	A1
1) TULCEA MUNICIPALITY, CIF (Fiscal Identification Code): 4321429, public domain		

**C. B. Part III. ENCUMBRANCES.**

Entries regarding dismemberment of property rights, real rights of guarantee and encumbrances	References
NOT EXISTING	

**Annex No. 1 to Part I****Land**

Cadastral no.	Surface (sqm)*	Observations / References
49098	5,203	Intra-urban land delimited by the conventional boundary, of which 857 square meters of green space, 580 square meters of parking and 2106 square meters of pavement. Public domain

\*The surface is determined in the Stereo 70 projection plane.

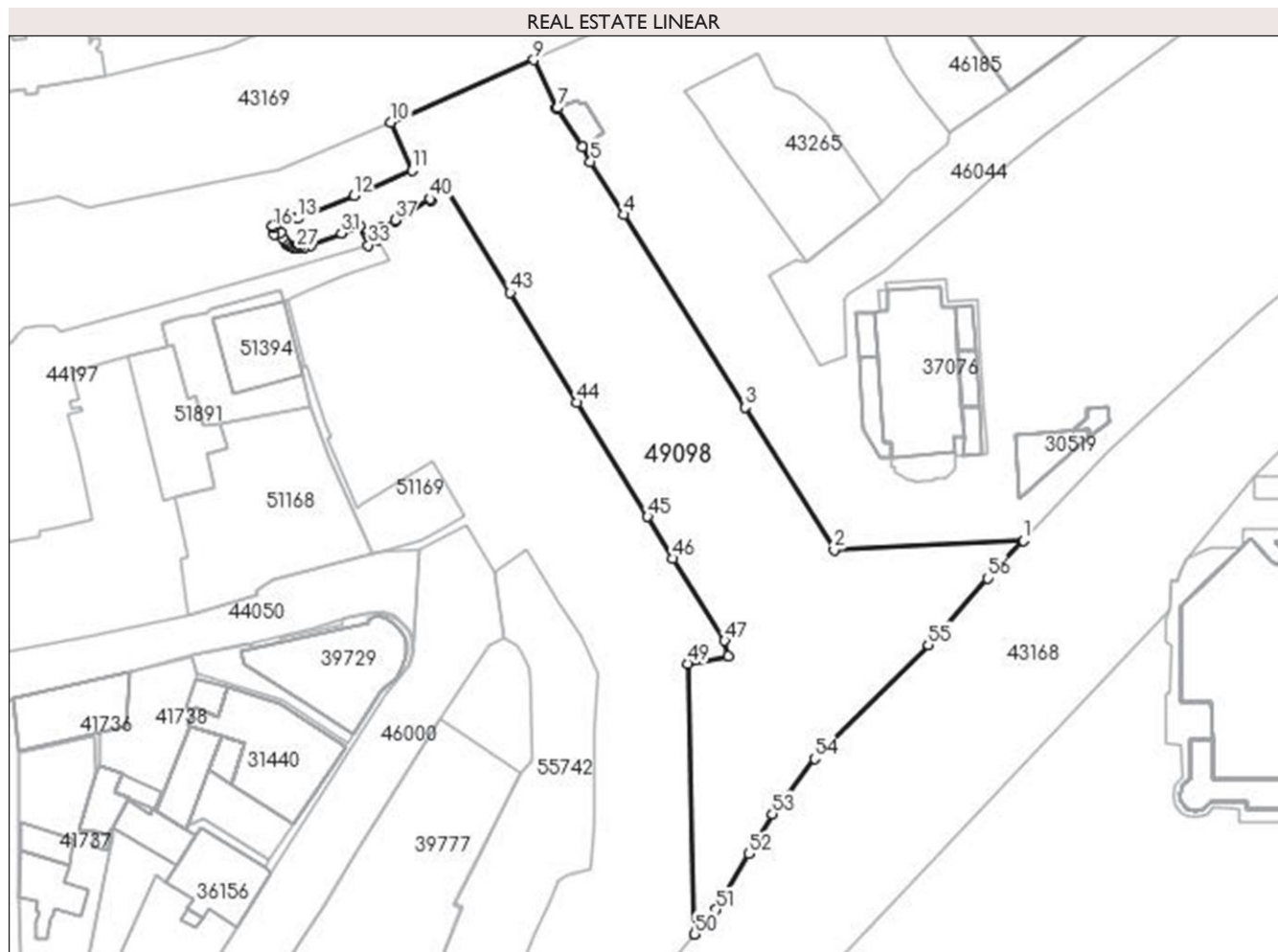
**Land related data**

Item no.	Usage category	Land within the built-up area	Surface (sqm)	Strip land	Lot	Topographical no.	Observations / References
1	road	YES	5,203	-	-	-	

**Segments length**

1) The segment length values are obtained from the plan projection.

Start point	End point	Segment length	Start point	End point	Segment length	Start point	End point	Segment length
1	2	36,439	2	3	32,493	3	4	43,848
4	5	12,114	5	6	3,322	6	7	8.84
7	8	0,285	8	9	10,377	9	10	30.03
10	11	10,102	11	12	12,182	12	13	11.83
13	14	0,216	14	15	4,953	15	16	0,335
16	17	1,249	17	18	1,246	18	19	1.09
19	20	0,664	20	21	0,604	21	22	0,351

Start point	End point	Segment length
22	23	0,368
25	26	0,339
28	29	0,918
31	32	3,843
34	35	1,905
37	38	0,173
40	41	0,336
43	44	24,908
46	47	18,684
49	50	52,235
52	53	8,929
55	56	17,195

Start point	End point	Segment length
23	24	0,331
26	27	0,459
29	30	1,307
32	33	4,134
35	36	1,593
38	39	2,767
41	42	3,688
44	45	25,84
47	48	3,112
50	51	6,305
53	54	13,446
56	1	9,978

Start point	End point	Segment length
24	25	0,489
27	28	0,502
30	31	6,391
33	34	2,006
36	37	3,007
39	40	5,211
42	43	23,047
45	46	9,485
48	49	7.86
51	52	12,456
54	55	31,024

\*\* Segment lengths are determined in the Stereo 70 projection plane and are rounded to 1 millimeter.

\*\*\* The distance between the points is made up of cumulative segments that are smaller than the value of 1 millimeter.

The Land Register extract generated by the integrated IT system of ANCPI contains the information from the land book active on the date of generation. This is valid under the conditions provided by art. 7 of Law no. 455/2001, in conjunction with art. 3 of the O.U.G. no. 41/2016, exclusively in the electronic environment, for activities and administrative processes provided by the legislation in force. The validity can also be extended in the physical form of the document, without the holographic signature, with the express or procedural acceptance of the public institution or entity that requested the presentation of this extract.

Verification of the correctness and reality of the information contained in the document can be done at the address **[www.ancpi.ro/verificare](http://www.ancpi.ro/verificare)**, using the online verification code available in the header. The verification code is valid for 30 calendar days from the moment the document is generated.

**Date and time of generation,**

17/04/2024, 12:43